

## SWITCH ASS'Y. TABLE ASS'Y.

(C-82-070-006-697)

ITEM	PART NUMBER	DESCRIPTION
1	070-006-695	Bracket - Switch Ass'y.
2	000-021-645	Switch Lever Ass'y.
3	000-026-042	Micro Switch
4	070-006-693	Shaft
5	070-006-694	Spacer
6	000-022-296	Insulator
7	000-024-657	Spring
8	963-200-002	Washer - "X" 9000-8
9	000-021-714	Adjusting Screw
10	835-550-002	Jam Nut 1/4-28
11	818-227-162	Sems Screw Rd. Hd. CR11 Ex. LW. (#6-32 x 1" LG)
12	839-527-002	FlexLoc Nut #6032 #21FA-6-32

## Switch Ass'y. Table Ass'y.

82-070-007-111

13	070-002-763	Pin & Bracket Weldment
14	070-002-762	Spring

## Switch & Lever Ass'y.

(70A Mach. To Ser. #93200)

15	070-002-713	Bracket
16	070-002-714	Actuator
17	070-002-758	Lever and Bushing Ass'y.
18	070-002-652	Bushing
19	070-002-653	Bushing
20	808-640-141	Screw 10-32 x 7/8
21	843-140-002	Keps Nut 10-32
22	948-745-082	Flat Washer
23	000-026-247	Micro Switch
24	813-727-162	Screw Phil Pan Hd. 6-32 x 1
25	838-727-002	Nut ESNA 6-32

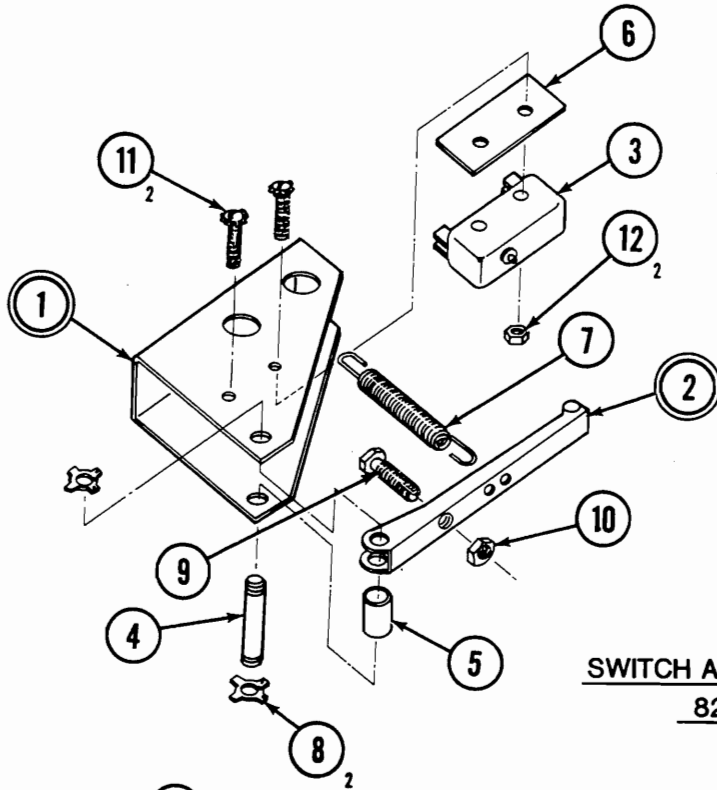

**SWITCH ASSEMBLY TABLE ASSEMBLY**  
82-070-006-697

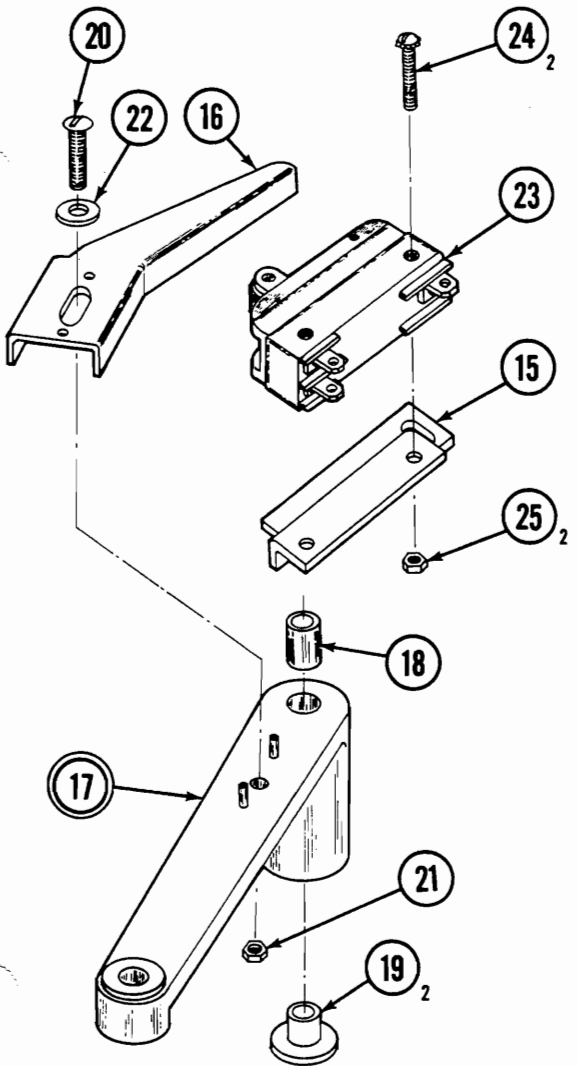

**SWITCH & LEVER ASSEMBLY**  
 ( 70 A MACHINE TO SERIAL # 93200 )

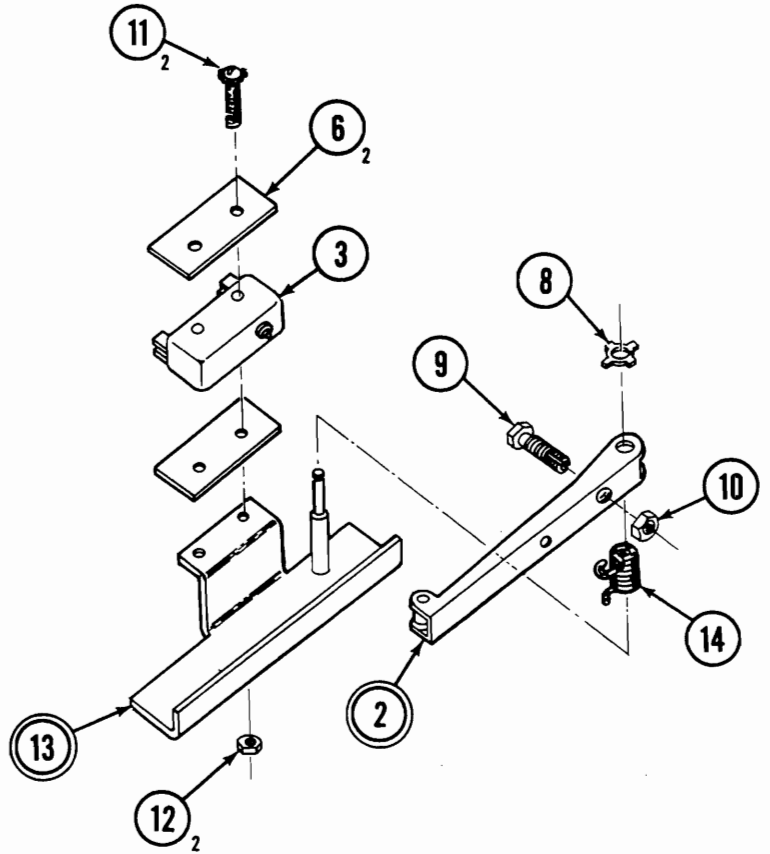

**SWITCH ASSEMBLY TABLE ASSEMBLY**  
82-070-007-111