

**KICKBACK ASS'Y. - SIDE OPP. BALL EXIT**

Ref. Drwgs. 070 002 020 L.H. Side/R.H. Mach. (Shown)

070 002 240 R.H. Side/L.H. Mach.

ITEM	PART NUMBER	DESCRIPTION	ITEM	PART NUMBER	DESCRIPTION
1	000 024 508	Pin Ejector Ass'y. R.H.	23	919 005 800	Truarc Ret. Ring
1a	000 024 507	Pin Ejector Ass'y. L.H. (Not Shown)	24	900 112 203	Plain Sleeve Brg.
2	000 024 511	Bracket Ass'y. R.H.	25	710 501 009	Alemite Fitting - #3006-1
2a	000 024 510	Bracket Ass'y. L.H. (Not Shown)	26	000 022 788	Support Box
3	000 025 803	Roller	27	000 022 300	Shield
4	000 025 804	Shaft	28	000 022 795	Block - L.H.
5	000 024 513	Spring-R.H.	28a	000 022 794	Block - R.H. (Not Shown)
5a	000 024 512	Spring-L.H. (Not Shown)	29	809 865 165	Hx. Hd. Cap Scr. $\frac{3}{8}$ -16 x 1
6	919 005 400	TruArc Retaining Ring	30	809 865 645	Hx. Hd. Cap Scr. $\frac{3}{8}$ -16 x 4-Gr. 8
7	963 600 002	"X" Washer	31	000 021 204	Spring
8	000 029 317	Pin Stop	32	000 023 431	Clip - Bottom - R.H.
9	000 024 515	Bushing - Long	32a	000 023 432	Clip - Bottom - L.H. (Not Shown)
10	000 024 516	Bushing - Short	33	000 023 468	Bracket
11	000 028 334	Washer	34	809 849 125	Hx. Hd. Cap Scr $\frac{1}{4}$ -20 x $\frac{3}{4}$ - Gr. 8
12	809 857 165	Scr. - Hx. Hd. Cap - $\frac{5}{16}$ -18 x 1	35	844 049 002	Stover Locknut - $\frac{1}{4}$ -20
13	000 023 821	Clip Weld.	36	000 024 890	Set Screw
14	839 665 002	Nut - Flexloc - $\frac{3}{8}$ -16	37	000 023 467	Bushing
15	951 164 002	LockWasher	38	844 057 002	Locknut - $\frac{5}{16}$ -18
16	948 767 132	Plain Washer	39	070 002 027	Panel
17	000 023 464	Support Weld. - R.H. Rear Roller	40	937 000 000	Steel Drive Rivet
17a	000 023 465	Support Weld. - L.H. Rear Roller (Not Shown)	41	000 022 878	Angle
18	000 022 924	Support Bearing	42	809 857 125	Hx. Hd. Cap Scr. - $\frac{5}{16}$ -18 x $\frac{3}{4}$
19	000 027 645	Bearing Ass'y. Brk't. L.H. For R.H. Mach.	43	070 007 373	Pit Support Weld.-L.H. For R.H. Mach.
19a	000 027 646	Bearing Ass'y. Brk't. R.H. For L.H. Mach.	43a	070 007 375	Pit Support Weld.-R.H. For L.H. Mach. (Not Shown)
20	008 100 413	Loctite Adhesive #404	44	844 074 002	Stover Lock Nut
21	000 027 642	Washer-Front Roller	45	941 072 200	Flat Washer $\frac{1}{2}$ x $1\frac{1}{4}$ x .083
22	000 027 641	Thrust Brg.	46	000 029 015	Pivot Stud
			47	000 026 464	Kickback Pit Bracket
			48	709 007 037	Taper Bolt
			49	937 738 003	Steel Rivet

KICKBACK ASSY.  
 REF. DIMS.: 070-002-020 L.H. SIDE/R.H. MACH. (SHOWN)  
 070-002-240 R.H. SIDE/L.H. MACH.

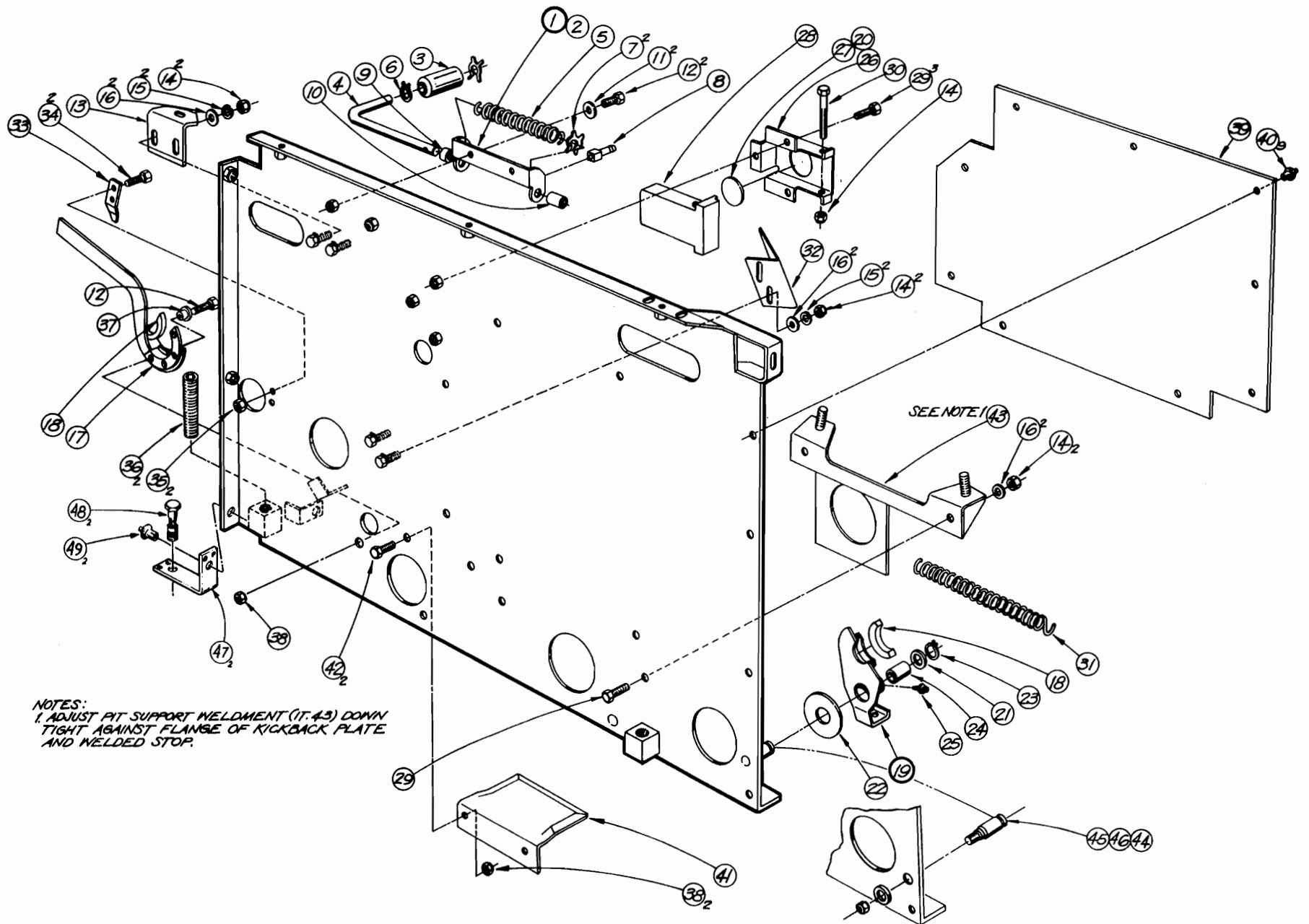

NOTES:  
 1. ADJUST FIT SUPPORT WELDMENT (IT. 43) DOWN  
 TIGHT AGAINST FLANGE OF KICKBACK PLATE  
 AND WELDED STOP.

SEE NOTE 1 (43)

FIELD INSTALLATION ONLY

Rev 5-83