

FRONT END FRAME & PLATFORM ASSEMBLY – ODD MACHINE

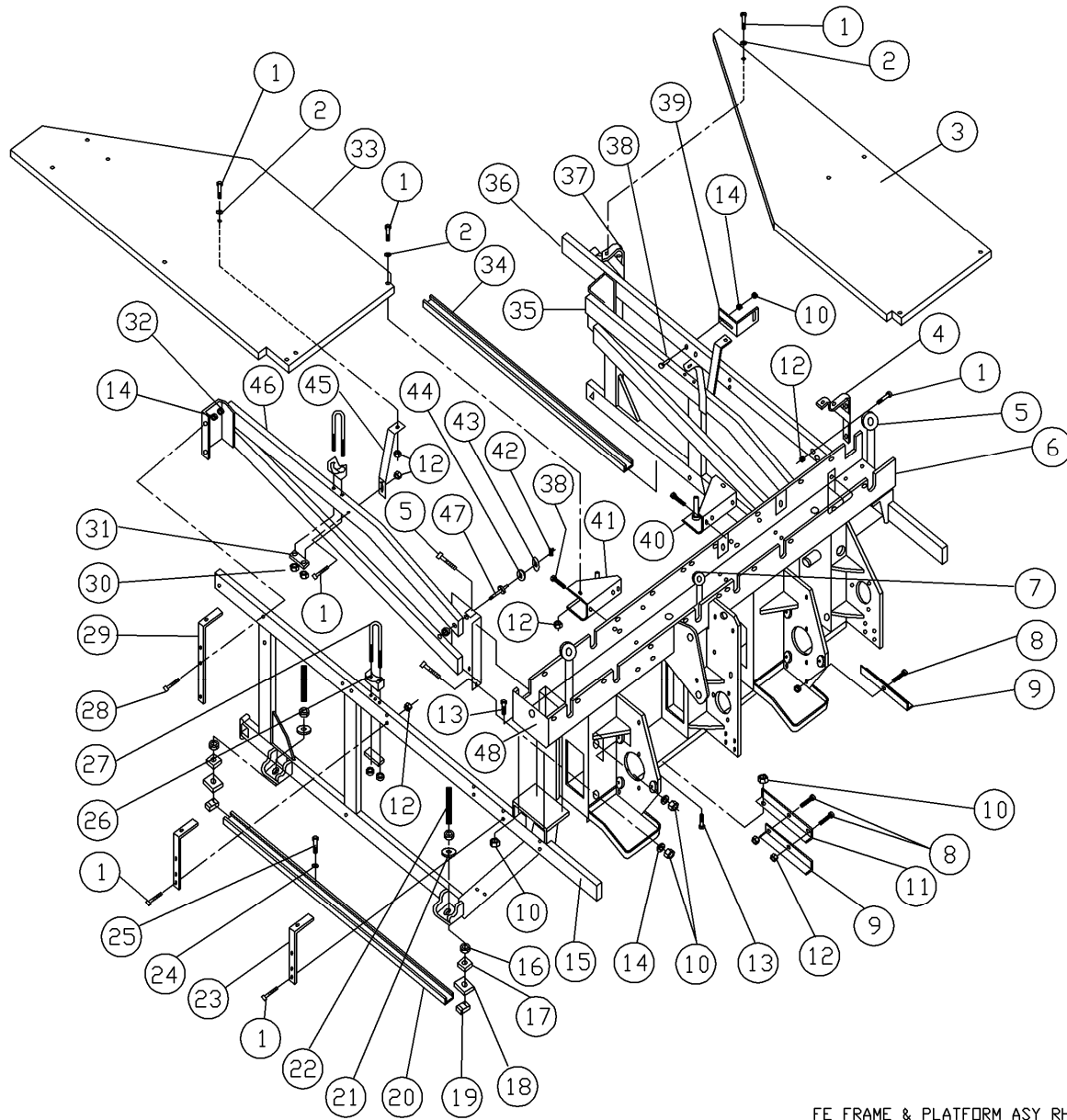

FE FRAME & PLATFORM ASY RH



FRONT END FRAME & PLATFORM ASSEMBLY – ODD MACHINE

ITEM	QTY	PART #	DESCRIPTION	ITEM	QTY	PART #	DESCRIPTION
1	20	809-849-285	SCREW, HEX, 1/4 -20 X 1-3/4	27	4	804-557-731	U-BOLT, SWEEP MOUNTING
2	5	948-753-102	WASHER, FLAT, 5/8 X 9/32 X 1/16	28	4	809-865-325	SCREW, HEX, 3/8 -16 X 2
3	1	070-006-425	PLATFORM, R.H.	29	1	070-006-405	ANGLE WELDMENT
4	1	070-001-819	PLATFORM SUPPORT WELDMENT	30	8	844-057-002	NUT, HEX LOCK, 5/16 -18
5	2	250-001-046	GROMMET, LARGE	31	4	070-008-126	CLAMP BAR
6	1	088-200-566	CROSS BEAM WELDMENT	32	1	840-065-002	NUT, FLEX LOCK, THIN, 3/8 - 16
7	8	711-520-017	GROMMET, SMALL	33	1	070-006-426	PLATFORM, L.H.
8	4	809-849-125	SCREW, HEX, 1/4 -20 X 3/4	34	1	070-007-844	UNISTRUT, SHORT
9	2	070-001-698	PIT LIGHT BRACKET	35	1	090-005-647	INNER SIDE BRACE R.H.
10	24	839-665-002	NUT, HEX LOCK 3/8 -16	36	1	090-004-002	SIDE FRAME, R.H.
11	1	070-001-596	ANGLE BRACKET	37	1	070-006-414	PLATFORM SUPPORT BRACKET
12	14	844-049-002	NUT, STOVER LOCK, 1/4 -20	38	4	809-865-285	SCREW, HEX, 3/8 -16 X 1-3/4
13	18	809-865-165	SCREW, HEX, 3/8 -16 X 1	39	2	070-004-654	TRACK SUPPORT BRACKET
14	25	948-767-132	WASHER, FLAT, 13/16 X 13/32 X 1/16	40	1	070-006-411	BRACKET WELDMENT (BIN ASSEMBLY, R.H.)
15	1	090-004-006	SIDE FRAME, L.H.	41	1	070-006-413	BRACKET WELDMENT (BIN ASSEMBLY, L.H.)
16	8	835-573-002	NUT, HEX JAM, 1/2 -13	42	1	963-400-002	X-WASHER
17	4	070-007-509	ELEVATING NUT	43	1	945-867-242	WASHER, 13/32 X 1-1/2
18	4	000-021-786	FRAME ADJUSTMENT PLATE	44	4	090-003-795	COUNTERBALANCE SPRING ROLLER
19	4	853-500-001	UNISTRUT NUT	45	3	070-006-490	PLATFORM SUPPORT BRACKET
20	1	070-007-843	UNISTRUT, LONG	46	1	090-005-646	INNER SIDE BRACE L.H.
21	4	000-021-787	WASHER, 9/16 X 1-5/8 X 1/4, BLACK	47	4	090-002-028	PIN SPRING ROLLER
22	4	070-007-510	ELEVATING SETSCREW	48	1	090-005-034	END PLATE
23	2	070-001-817	PLATFORM ANGLE WELDMENT				
24	8	948-761-112	WASHER, FLAT, 11/16 X 11/32 X 1/16				
25	8	810-556-320	SCREW, HEX LAG, 5/16 X 2				
26	4	000-021-528	SADDLE				