

SPOT & RESPOT LINKAGES

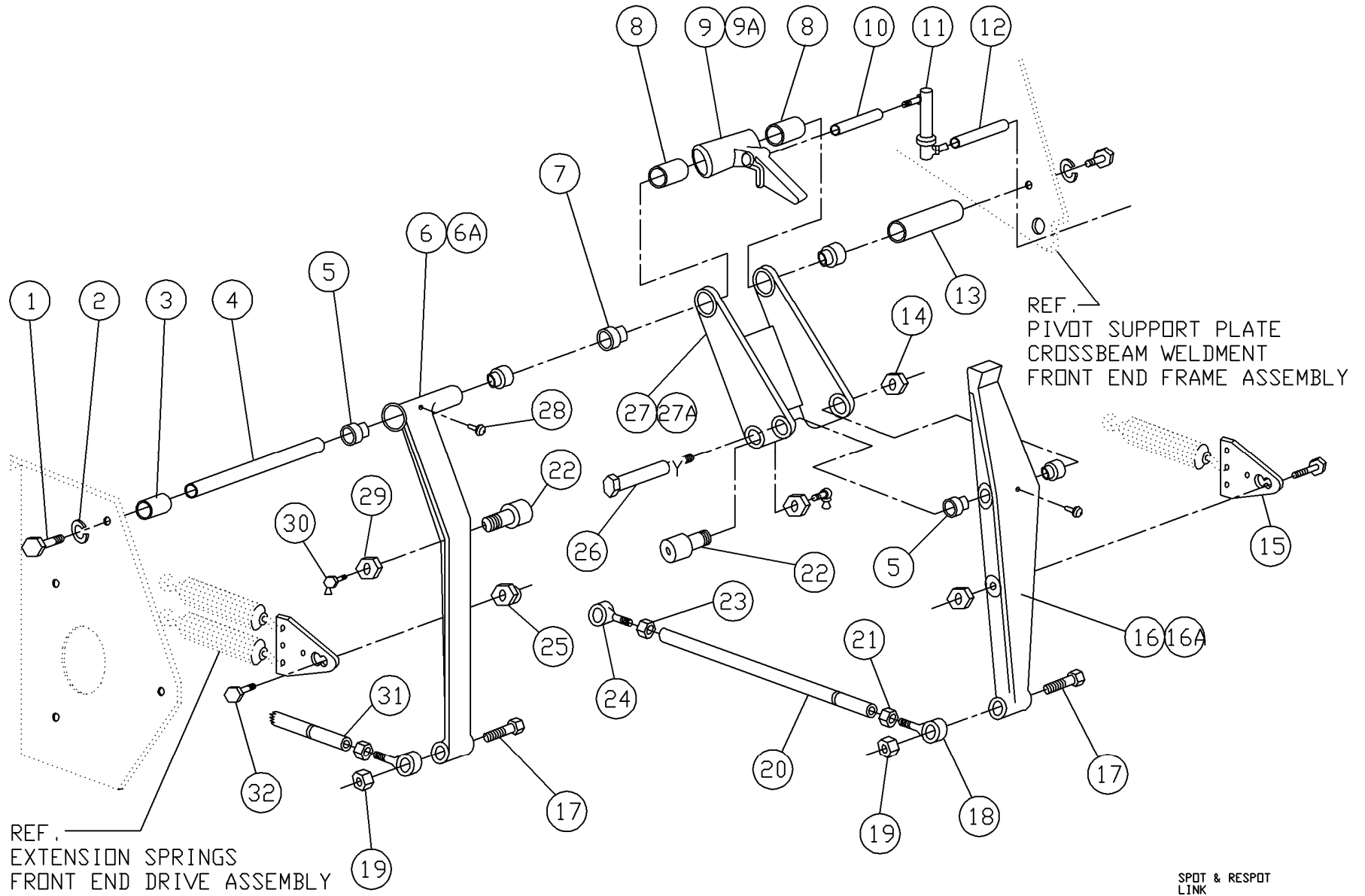



SPOT & RESPOT LINKAGES

ITEM	QTY	PART #	DESCRIPTION	ITEM	QTY	PART #	DESCRIPTION
1	2	809-865-125	SCREW, HEX, 3/8 - 16 X 3/4	24	2	090-005-265	END FITTING, 7/16-20, R.H. THREADS
2	2	951-164-002	WASHER, SPLIT LOCK, 3/8	25	2	839-665-002	NUT, FLEX LOCK, 3/8 - 16
3	1	090-005-534	SPACER	26	1	070-001-585	SPOT LINK PIN
4	1	090-005-025	PIVOT SHAFT, 5/8 X 8-5/8	27	1	070-001-565	UPPER SPOTTING LINK
5	4	070-001-919	FLANGED BEARING, .627 X .814 X .870	27A	1	070-001-605	UPPER SPOTTING LINK ASSY. (incl. 7 & 27)
6	1	070-006-459	RESPOT ARM LINK	28	2	710-501-009	GREASE FITTING
6A	1	070-006-492	RESPOT ARM LINK ASSY. (incl. 5, 6, & 28)	29	2	844-070-002	NUT, STOVER LOCK, 7/16 - 20
7	2	070-002-691	FLANGED BEARING, .627 X .752 X 1/2	30	2	710-501-012	GREASE FITTING
8	2	900-110-141	SLEEVE BEARING, .628 X .878 X 7/8	31	1	Not for sale	RESPOT TIE ROD (ROD ONLY) see pg 27.
9	1	070-001-996	SPOTTING ARM LATCH	32	2	070-001-587	SPRING HANGER PIN
9A	1	090-005-552	SPOTTING ARM LATCH ASSY. (incl. 8 & 9)				
10	1	913-464-400	SPRING PIN				
11	1	070-006-493	BALL JOINT ASSEMBLY				
12	1	913-464-480	SPRING PIN, 3/8				
13	1	090-005-564	SPACER, LONG				
14	1	844-073-002	NUT, STOVER LOCK, 1/2 - 13				
15	2	090-005-576	SPRING HANGER				
16	1	070-006-479	RESPOT ARM LINK				
16A	1	070-006-481	SPOTTING ARM LINK ASSY. (incl. 5, 16, & 28)				
17	2	809-869-365	SCREW, HEX, 7/16 - 14 X 2 1/4				
18	2	090-005-264	END FITTING, 7/16-20, L.H. THREADS				
19	2	844-069-002	NUT, STOVER LOCK, 7/16 - 14				
20	1	Not for sale	SPOT TIE ROD (ROD ONLY) see pg 27.				
21	2	835-670-002	NUT, JAM, 7/16-20, L.H. THREADS				
22	2	070-006-728	CAM FOLLOWER BEARING ASSEMBLY				
23	2	835-570-002	NUT, JAM, 7/16-20, R.H. THREADS				