

KICKBACK ASS'Y.

Ref. Dwgs. 070-011-202 R.H. - Shown

070-011 201 L.H.

ITEM	PART NUMBER	DESCRIPTION	ITEM	PART NUMBER	DESCRIPTION
1	070 011 006	Door Weldment - R.H.	21	000 022 300	Shield
2	070 011 005	Door Weldment - L.H. (Not Shown)	22	000 022 794	Block - R.H.
3	000 024 668	Track Supp't. Brk't. Weldment	22a	000 022 795	Block - L.H. (Not Shown)
4	808 857 120	Fl. Hd. Soc. Scr. - $\frac{5}{16}$ -18 x $\frac{3}{4}$	23	809 865 645	Hx. Hd. Cap Scr. - $\frac{3}{8}$ -16 x 4-Gr. 8
5	844 057 002	Stover Locknut - $\frac{5}{16}$ -18	24	840 065 002	Nut-Flexloc- $\frac{3}{8}$ -16
6	000 029 672	Bearing Ass'y. Bracket - R.H.	25	008 100 413	Loctite Adhesive #404
6a	000 022 249	Bearing Ass'y. Bracket - L.H. (Not Shown)	26	000 029 640	Panel
7	000 022 924	Support	27	937 000 000	Steel Drive Rivet - Southco
8	900 112 203	Plain Sleeve Bearing	28	070 011 286	Bushing-Curtain Rod
9	710 501 009	Fitting - Alemite #3006-1	29	808 549 160	Soc. But. Hd. Scr. - $\frac{1}{4}$ -20 x 1
10	000 021 204	Spring	30	844 049 002	Stover Locknut - $\frac{1}{4}$ -20
11	070 007 372	Pit Support Weldment - R.H./R.H.	31	070 006 639	"C" Washer
11a	070 007 374	Pit Support Weldment - L.H./L.H. (Not Shown)	32	070 007 722	Set Screw - $\frac{1}{4}$ -20 x 3
12	809 865 205	Hx. Hd. Scr. - $\frac{3}{8}$ -16 x 1 $\frac{1}{4}$	33	000 024 624	Rear Segment R.H. Shown
13	839 665 002	Nut - Flexloc - $\frac{3}{8}$ -16	33a	000 024 623	Rear Segment L.H.
14	000 022 878	Angle	34	000 024 625	Front Segment R.H. Shown
15	809 857 125	Hx. Hd. Scr.- $\frac{5}{16}$ -18 x $\frac{3}{4}$	34a	000 024 626	Front Segment L.H.
16	000 027 642	Washer-Front Roller Supp't.	35	808 857 160	Screw Flt. Soc. Hd. $\frac{5}{16}$ -18 x 1
17	000 027 641	Thrust Bearing	36	000 022 926	Retainer
18	919 005 800	Retaining Ring - 5100-75	37	839 758 002	Nut FlexLock $\frac{5}{16}$ -24
19	000 024 890	Set Screw	38	810 258 100	Screw Soc. Hd. Cap $\frac{5}{16}$ -24 x $\frac{5}{8}$
20	000 022 788	Support Box	39	000 025 207	Lock, Jack Screw (Not Shown)
			40	000 028 362	Bumper

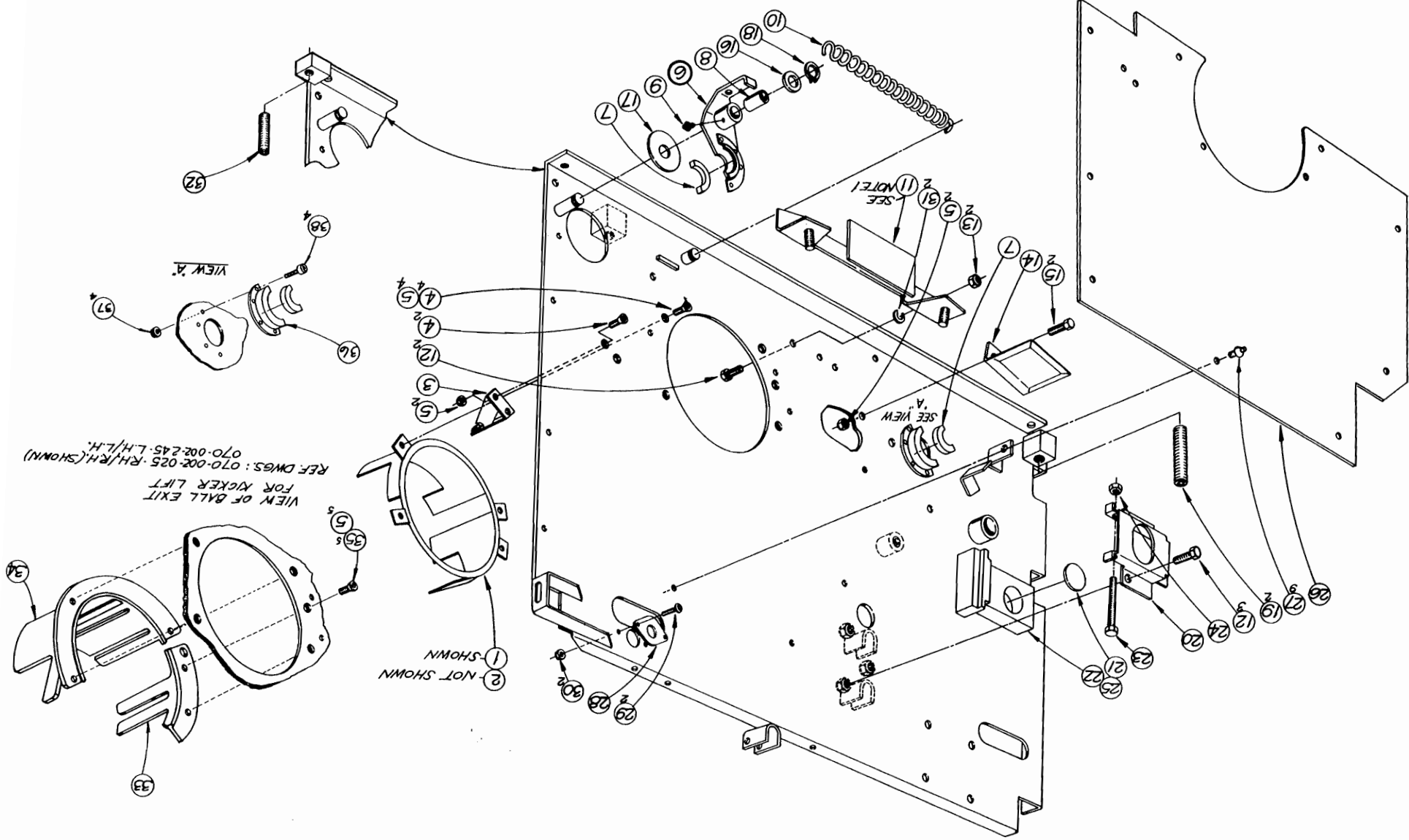

VIEW OF BALL EXIT
FOR KICKER LIFT
REF DWGS: 070-002-025 - R.H./R.H. (SHOWN)
070-002-245 - L.H./L.H.

1 - NOT SHOWN
2 - NOT SHOWN

KICKBACK ASS'Y
REF DWGS: 070-011-202 - R.H./R.H. (SHOWN)
070-011-201 - L.H./L.H.

NOTES:
1. ADJUST PRT SUPPORT WELDMENT (T11)
TIGHT AGAINST FLANGE OF KICKBACK
PLATE AND WELDED STOP.