

KICKBACK PLATE ASSEMBLY- BALL EXIT SIDE

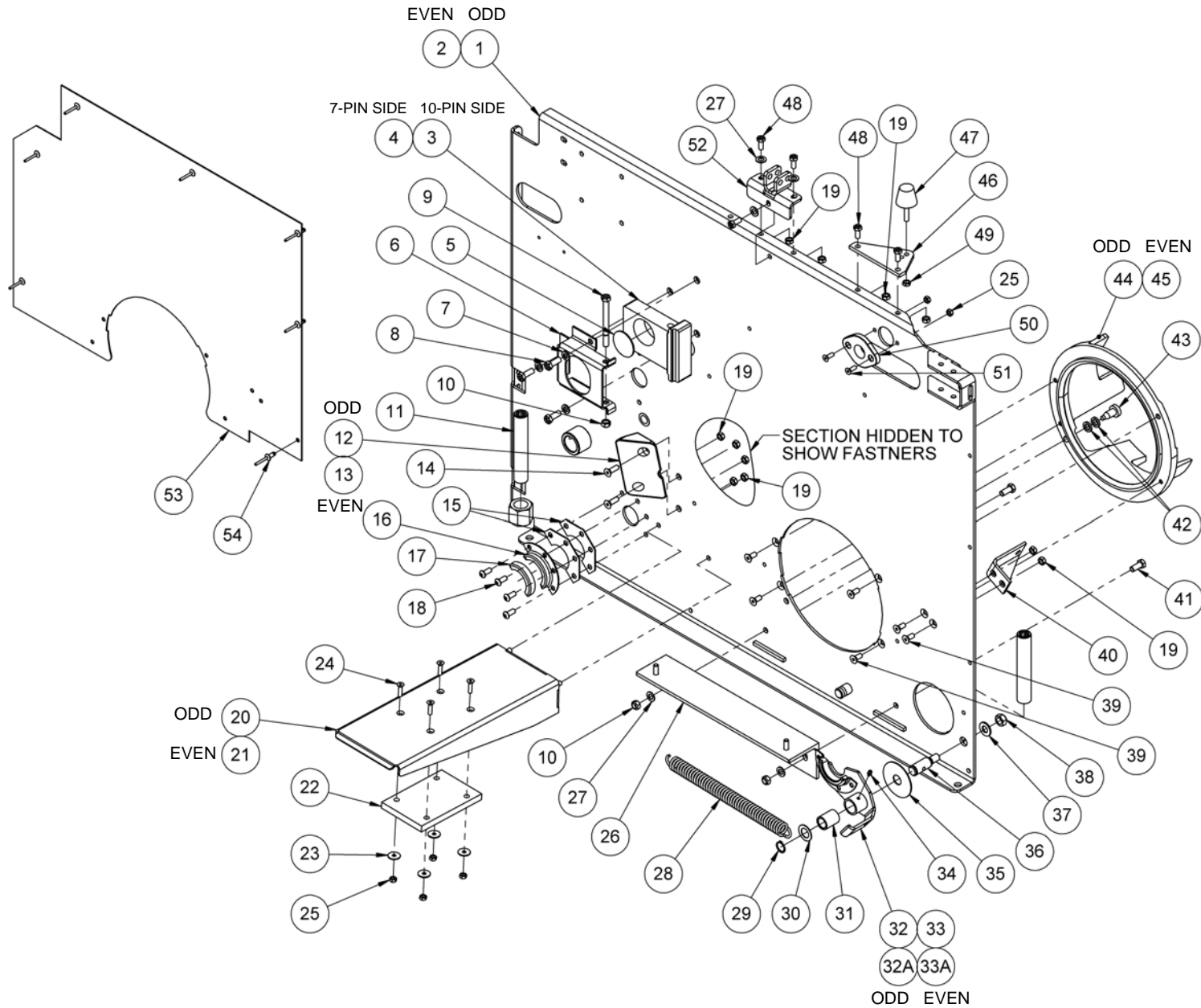



KICKBACK PLATE ASSEMBLY- BALL EXIT SIDE

ITEM	QTY	PART #	DESCRIPTION
1	1	088-001-593	KICKPLATE. 10-PIN SIDE.. ODD MACHINE
2	1	088-001-592	KICKPLATE. 7-PIN SIDE.. EVEN MACHINE
3	1	000-022-794	BLOCK SUPPORT. 10-PIN SIDE
4	1	000-022-795	BLOCK SUPPORT. 7-PIN SIDE
5	1	000-022-300	SHIELD
6	1	000-022-788	BOX SUPPORT
7	3	951-164-002	WASHER. SPLIT LOCK. 3/8
8	5	809-865-165	SCREW. HEX. 3/8 - 16 X 1
9	1	809-865-645	SCREW. HEX. 3/8 - 16 X 4
10	3	844-065-002	NUT. STOVER LOCK. 3/8 - 16
11	2	000-024-890	SETSCREW
12	1	088-001-567	ANTI-IDLING CORNER. ODD
13	1	088-001-568	ANTI-IDLING CORNER. EVEN
14	2	808-867-160	SCREW. FLAT HEAD. 5/16-18 X 1
15	2	090-004-136	SPACER
16	1	000-022-926	RETAINER SUPPORT
17	2	000-022-924	BEARING SUPPORT
18	4	808-557-120	SCREW. BUTTON HEAD. 5/16 - 18 X 3/4
19	8	844-057-002	NUT. FLEX LOCK. 5/16 - 24
20	1	088-001-571	ANTI-IDLING CHANNEL WELDMENT. ODD
21	1	088-001-572	ANTI-IDLING CHANNEL WELDMENT. EVEN
22	1	088-001-583	ANTI-IDLING NOISE PAD
23	4	000-026-865	FLAT WASHEER. 3/8 X 7/8 X 1/16
24	4	808-849-160	SCREW. FLAT HEAD. ¼-20 X 1
25	6	844-049-002	NUT. STOVER LOCK. 1/4 - 20
26	1	090-004-131	PIT SUPPORT BRACKET
27	2	948-767-132	WASHER. 13/32 X 13/16 X 1/16
28	1	000-021-204	SPRING
29	1	919-005-800	RETAINING RING
30	1	000-027-642	FRONT ROLLER SUPPORT WASHER
31	1	900-112-203	SLEEVE BEARING. .753 X 1-1/4

ITEM	Q	PART #	DESCRIPTION
32	1	000-029-602	BRACKET WELDMENT. 10-PIN SIDE. ODD MACHINE
32A	1	000-029-672	BEARING BRACKET ASSEMBLY. 10-PIN SIDE ODD MACHINE (Includes 17, 31, 32, & 34)
33	1	000-022-248	BRACKET WELDMENT 7-PIN SIDE. EVEN MACHINE
33A	1	000-022-249	BEARING BRACKET ASSEMBLY. 10-PIN SIDE EVEN MACHINE (Includes 17, 31, 33, & 34)
34	1	710-501-009	GREASE FITTING
35	1	000-027-641	THRUST BEARING
36	1	000-029-015	PIVOT STUD
37	1	948-975-172	WASHER. FLAT. 1 X 1/2 X 1/16
38	1	844-074-002	NUT. STOVER LOCK. 1/2 - 20
39	6	808-857-120	SCREW. FLAT HEAD. 5/16 - 18 X 3/4
40	1	000-024-668	TRACK SUPPORT BRACKET
41	2	809-865-145	SCREW. HEX. 3/8-16 X 7/8
42*	1*	070-011-050	WASHER. SPECIAL
43	1	000-028-362	BUMPER. URETHANE
44	1	070-011-642	URETHANE DOOR RING. ODD MACHINE. 10-PIN SIDE
45	1	070-011-641	URETHANE DOOR RING. EVEN MACHINE. 7-PIN SIDE
46	1	070-004-642	BALL LIFT STOP BRACKET
47	1	000-024-641	STOP BUMPER
48	5	809-857-125	SCREW. HEX. 5/16 - 18 X 3/4
49	1	835-558-002	NUT. HEX JAM. 5/16 - 24
50	1	088-500-190	CURTAIN ROD BUSHING. CS
51	2	088-849-120	SCREW. BUTTON HEAD. 1/4 - 20 X ¾
52	1	088-001-034	SINGLE SADDLE BRACKET WELDMENT
53	1	000-029-640	KICKBACK PANEL
54	7	938-648-010	RIVET. .25 X .48. AL
n/a	1	008-100-413	ADHESIVE (apply between items 3&5 or 4&5 as applicable)

* 0, 1, or 2 washers depending on the distance between the two machines' kickback plates.